



Mary, her mother, and her siblings in the Greenwood internment camp in July, 1942

March 29, 1942

Acting on behalf of the Custodian of Enemy Property, a family friend, Gavin C. Mouat, inventories the Murakami property on Salt Spring Island.

August 19, 1942

An agent of the Soldier Settlement Board appraises the farm.

February 25, 1943

Mary's father, Katsuyori, inquires about the protection of his farm and belongings.

June 26, 1943

Mary's older sister, Alice, accuses Mouat of betrayal.

July 5, 1943

An official, H.F. Green, promises to investigate and questions Mouat.

September 18, 1943

Katsuyori requests funds "for clothes for winter."

1948

Katsuyori receives a receipt for the forced sale of his farmland.

MARY MURAKAMI



MARCH 29, 1942

To Mr. C. L. Drewry,
Custodian's Office,
Vancouver, B. C.

EXHIBIT No.

625-6

DATE

August 27/48

FILLED BY

H. A. Rice

REPORT RE: KATSUYORI MURAKAMI, REGN. NO. 10089

Investigation & Inventory made Sun., March 29/42

(1) The legal description of land is as follows:

PARCEL 1: Lot 1, of Sec. 3, R.II.E., Plan 3912 of North Salt Spring, Cowichan District, containing ten (10) acres. Annual taxes \$11.00 paid up to end of 1941. About 4 acres cleared and about 1 acre covered with buildings; balance partially cleared and cultivated.

PARCEL 2: That part of E. 1/2 of Sec. 3, R.II.E., as shown on Plan 246R, of North Salt Spring, Cowichan District, containing seven (7) acres. Annual taxes \$7.70 paid to the end of 1941. About three acres cleared and cultivated, balance partially cleared.

Parcel 1 is registered in the name of the above Katsuyori Murakami, Registration No. 10089, and title deeds are held by wife of the said Katsuyori Murakami.

Parcel 2 is held by Katsuyori Murakami under Agreement from Mr. T. F. Speed of Ganges. Under the Agreement of 13th day of November, 1938, the total purchase price was \$400 and there is a balance of \$400 principal owing to Mr. Speed, plus interest at 7% from November 13th, 1941. Title deeds are held by Mr. Speed.

Katsuyori Murakami
is Mary's father.

(3) The above property is located about two miles from Ganges wharf and is near the main road. There are 7 acres of good garden land in crop. The balance of the land is not sufficiently cleared for crop purposes. The present crops are asparagus 3 acres, strawberries 3 1/2 acres, loganberries 1/2 acre. All these crops have been very well kept. The buildings consist of a four-room living house, 6 chicken houses approximately 20 ft. x 50 ft. each, 1 brooder house 18 ft. x 46 ft., 1 incubator house 14 ft. x 10 ft., 1 feed shed, 1 wash house, 1 woodshed, 2 packing houses, 1 other small outhouses. The buildings are all in a fair state of repair.

This is Mary's home.

(4) The property was inspected Sunday, March 29, 1942, and inventory made as follows:

~~5~~ shovels
~~2~~ rakes
~~2~~ cultivators
3 double bitted axes
~~5~~ hoes
4 Japanese large cultivators
2 " " " "
2 potato " "
1 peevie " "
1 Japanese hand size " "
1 " " " "
5 " Scythes
2 hatchets
1 pump (liquid)
~~1~~ water sprinkler
1 cross cut saw
~~2~~ sledge hammers
~~1~~ large Japanese saw
~~1~~ small " "

Inventory, Cont'd.

1 scale	1 1200 egg electric incubator
1 large scale	(cost \$150)
1 scale	1 lamp incubator (cost \$100)
1 straw cutter	1 incubator (cost \$15)
25 baskets - 4	6 small water fountains
2 hand saws	3 large " " \$2.10
1 Japanese hand saw	3 small " " 1.95
1 " plane	.45
1 screw driver	1 new door, 5 panel 8'6" x 5'6"
1 Japanese chisel	1 electric iron
1 wheelbarrow	1 fry pan
2 large baskets	1 dish pan
2 hammers	1 preserving kettle
1 square	1 cash box
1 box misc. small tools	1 box odd dishes and glassware
about 40 sacks clam shell	1 box knives, egg beater & other
1 Singer Sewing Machine	kitchen hardware
1 sideboard with mirror	6 sauce pans, aluminium
3 tables & 6 chairs	2 roast pans
1 Japanese tray	1 double boiler
4 beds, double & full	1 black board
1 baby crib	4 platters
1 chest of drawers	2 fruit dishes
3 cartons rubber bands for asparagus	12 tea spoons (Andover silver)
3 Japanese ornaments	6 white handle knives, stainless
1 bench	7 forks
1 trunk of clothes	30 saucers
1 kitchen stove	20 cups
2 kettles	6 bread and butter plates
3 tea pots	11 dinner plates
125 asparagus crates, new	1 bowl
241 tomato punnets, new	1 tea pot
20 strawberry crates, new	10 fruit dishes
60 jam berry crates, used	50 ft. garden hose X
32 berry picking trays, used	1 child's play waggon
23 wooden berry pails	1 cultivator machine
2 empty wine barrels	(Reference to this item is made below)
35 gals. loganberry wine	
50 new jam berry crates	

(5)

The dwelling house is insured with the Norwich Union Fire Insurance Society for the sum of \$500. Policy No. 10222621, expires May 16th, 1943. No other insurance in force.

(6)

Liabilities owing to Mr. Speed as above mentioned \$400, plus interest at 7% from November 13th last. No other liabilities.

(7)

I suggest that if possible this property be rented to some responsible person who will look after and market the oncoming season to carry on and farm this property. I have negotiations along this line with a Chinese produce merchant, Mr. Cheu, and if negotiations reach a point it would be equitable I will immediately refer you for instructions.

Mary's neighbour, Gavin Mouat, offers to be responsible for the care of the Murakamis' property.

The above inventory was made very carefully by myself, but as the wife and family of the above mentioned Katsuyori Murakami are not yet evacuated and were in possession of the house, I considered it advisable to leave them in possession and to be responsible to me for the care of the property pending further arrangements.

I may say that when I investigated this property I found that the cultivating machine which K. Murakami had reported at Hastings Park and which is shown on page 2 of the registration form was missing, and on inquiry I found that it had been sold for a trifling sum the previous day. I took steps to have this machine returned to the property and instructed Mrs. Murakami that nothing was to be removed from the property without the permission of your office.

Gavin Mouat

AUGUST 19, 1942

The Soldier Settlement Board
uses these forms to determine
the value of Japanese
Canadians' farmlands.

BC/710-P
BC/2361-B

Page 1

S.S. Form No. 43
(Sheet 1)

Farm Appraisal Report

File No. J.L. 782

Lot 1, Sec. 3, Range 2 East, Plan 3912
Land Description That part of E₂ of Sec. 3, R. 2 E., Plan 246 R., North Salt Spring Island.

Containing 10 acres & 7.04 = 17.04 Acres

Owner's Name Katsuyori MURAKAMI Post Office Address R. R., Ganges, B. C.

Nearest Rail Point N.A. C.P.R. boat service at Ganges Distance 1 1/2 miles

Market Town Vancouver or Victoria Distance 40 "

Church (give denomination) Protestant at Ganges Distance 1 - 1 1/2 miles.

Nearest School Ganges Consolidated Distance 1 - 1 1/4 "

State how property was identified: Road. Posts and map check.

Roads: State whether property has access to main road, the kind of road and its condition.

Yes, it has frontage on Public Road, gravelled, fair.

Is this district a good one? Fair, but rather far from markets.

Employment opportunity Strictly limited.

Predominating Nationality and religion: British, Protestant.

Describe Fencing and its condition: One good wire fence on west. Value \$

Water supply: Piped from property to south. Water license #10360. allows 1000 gallons per day. Applicable to Lot 1. Value \$

BUILDINGS ON FARM

BUILDINGS	DIMENSIONS	MATERIAL	HEIGHT	ROOF	AGE	Foundation	REPAIR	VALUATION
House & addn.	24x26x12	Frame	12	Shingle	approx	Wood	fair	500.00
HOUSE	10x17x7	"	"	"	15	"	"	300.00
Poultry hse.	20 x 60	"	9	"	5-6	"	"	10.00
Brooder hse.	12 x 14	"	6	Shake	10-15	"	Poor	250.00
"	18 x 46	"	9	"	10-15	"	Fair	10.00
Packing hse.	14 x 14	"	7	"	10-15	"	poor	10.00
" shed	12 x 14	"	7	"	10-15	"	"	10.00
Poultry shed	12 x 13	"	6	"	10-15	"	"	10.00
Brooder hse.	14 x 30	"	8	Shingle	5-6	"	good	150.00
GRANARY shed	18 x 22	"	8	Shake	10-15	"	Poor	50.00
Poultry hse.	18 x 50	"	7	"	10-15	"	Poor	50.00
"	18 x 50	"	7	"	10-15	"	Poor	25.00
"	18 x 45	"	7	"	10-15	"	Poor	125.00
"	20 x 30	"	8	Shingle	2-3	"	Good	50.00
"	8 x 50	"	8	Shake	10-15	"	Poor	

Electric light installed.

Total present day value \$ 1550.00

Total Value Buildings add to farm \$ 1000.00

Is dwelling habitable without repairs? Yes. If not what is your approximate estimate of cost to make it habitable? A good cleanout is all that is necessary. Has open fireplace.

Describe the basement and chimneys: No basement, brick chimneys to ground.

No. rooms downstairs? 4 Upstairs? -- How finished V. Joint

Are buildings painted? House. Yes. Condition of paint Fair

Distance from nearest bush All clear.

Note: Particular care must be taken when examining and reporting on foundations, sills and roofs.

Cultivated Land

BC/710-P
BC/2361-B

Page 2

ACRES	LEVEL, UNDULATING, ROLLING OR HILLY	SOIL (State Depth)	SUB- SOIL	KIND AND QUALITY OF CROP	VALUE PER ACRE	TOTAL
4.	gently sloping to south	light, sandy and shale	shaly with clay	strawberries, logans and asparagus.	50.00	200.00
Area which can be cultivated without cost other than for breaking.						
.25	Low level	clay loam	clay & shaly	drain for winter water	50.00	12.50
Area which can be cultivated after a reasonable amount of clearing timber, stones, drainage, etc.						
5.	Gentle rise to south	Light, sandy & shaly 8"	shaly clay	clear small conifers and dead fall	50.00 15.00	75.00
Area Unsuitable for Cultivation.						
7.79	Side hill, scrub trees, very shaly with rock outcrops, includes poultry, building sites.	CHARACTER OF LAND E. G. HILLY, SWAMPY, ROCKY.		NATURE OF TIMBER IF ANY AND WHETHER MARKETABLE	VALUE OF LAND PER ACRE	23.37

Total value of Land \$ 310.87

Total added by buildings to value of farm \$ 1000.00

Total fruit trees add to value of farm (for use in orchard districts only) \$

Total value of farm \$ 1310.87

Describe condition of farm commenting on tillage, length of time unoccupied or
Owner vacated about May. Land has been worked by the Chinese fir
Company Ltd. of Vancouver, rental not known. Dwelling is vacant

The total value that the Soldier
Settlement Board agent
assigns to the Murakami farm.

State most suitable type of agriculture for farm bearing in mind the district's limitations, if any.

In my opinion poultry on this very shaly soil would be in the long run more suitable than
small fruits.

Noxious weeds:

Lots of Canada Thistle.

Give approximate detail and
amount of all annual taxes and
names of Taxing Authorities:

Provincial taxes - Land and school
\$7.70 plus \$11.00 = \$18.70

Date: August 18, 1942.
Place: Victoria

I certify that the above report is based on a personal examination
of the whole farm made on the 6th day of August 1942

Inspector's Signature

"T. Godfrey"

Note: (Use Form 43 (Sheet 2) in connection with this form.)

J.L. 782

Remarks: On Salt Spring Island situated midway between Vancouver and Victoria and served by C.P.R. some four days a week. Very limited employment opportunities on the Island. Good shopping centre at Ganges. The land is entirely underlaid with shale. The water - 1000 gals. per day on Water License comes from other land to the south and would appear to be tapped in from a pipe line jointly with K. OKANO adjoining on the west. The actual source was not located. The 1000 gals. allowed daily would be adequate for domestic and poultry use, but for little else. The present Chinese operators are also handling two other Japanese properties adjoining. I could not ascertain amount of rental paid. Strawberries, Loganberries, and asparagus seem to have grown well in spite of the very pronounced shale. In my opinion only a Japanese or Chinaman would have attempted small fruits, etc. on this land. There is little or no fuel available.

REMARKS: re general lie of land, fertility of soil, irrigation, drainage or dyking and reclamation.

Present Value

[illegible]

Amount fruit trees add to value of farm \$.....

Diagram of Property

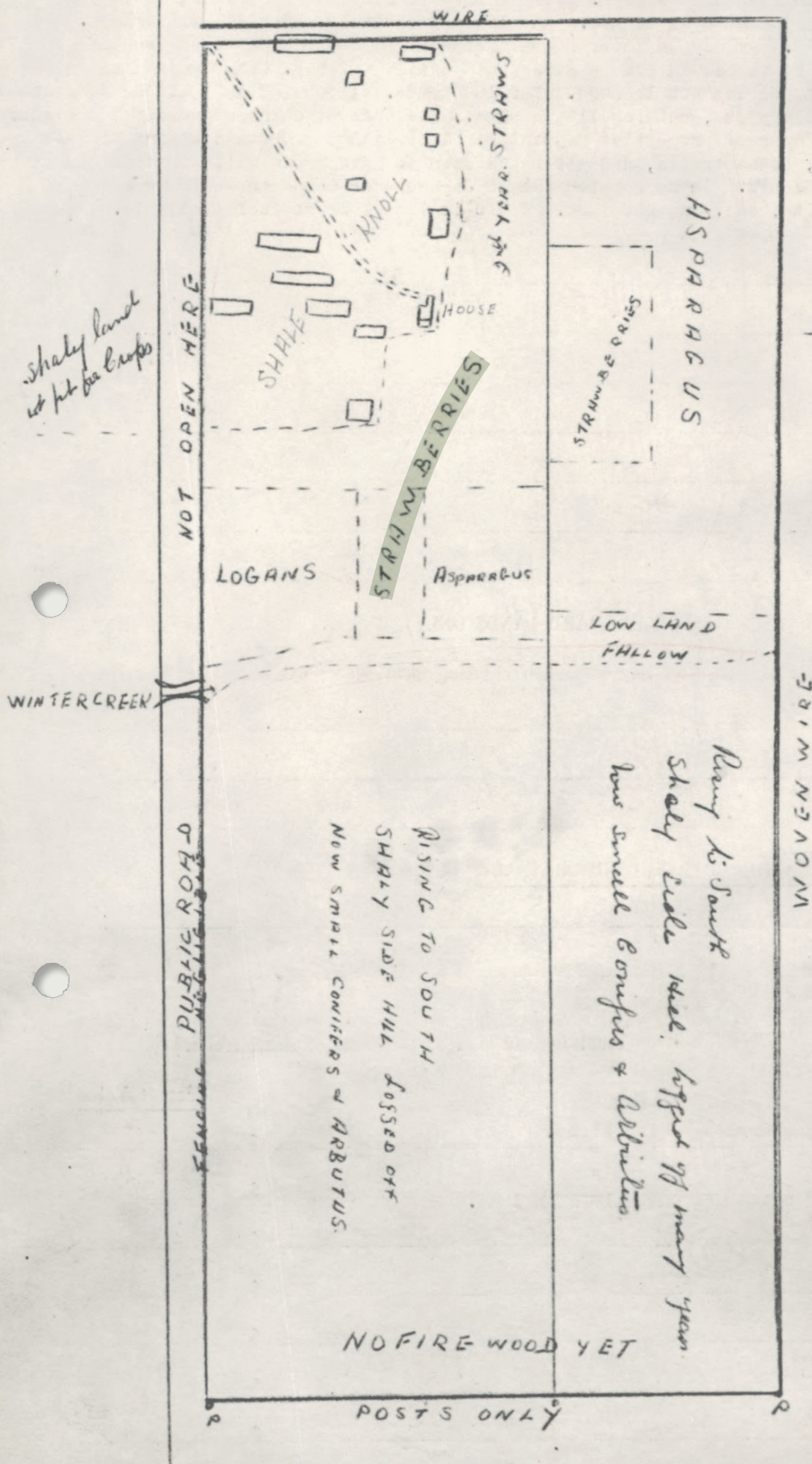

Scale 2 1/2" = 1"

The appraiser maps the Murakami farm.

Following careful review of this appraisal report, it is my opinion that the present

value is \$ 1300

Date 19th August 19 42

"I. T. Barnet"

District Superintendent.

FEBRUARY 25, 1943

House No. 208
Dosebury, B.C.
Feb. 25, 1943

The Custodian's Office
Department of the Secretary of State
of Canada
Vancouver, B.C.

Dear Sir,

I would like to know if somebody has leased our land. The army profit is coming out of our land. I would like to know the answer soon as possible.

Last year when we were leaving our home, we said that we would pay the tax before we left. But the Custodian Agent told us that we didn't need to pay it so we didn't. Could you tell us what is becoming of our tax. Could you tell us what has become of the tax. And quite a few while ago, we asked the Custodian to send our kitchen utensils, well all the things came but every aluminum things were missing. I would like to know what has become of them. Right now, as you know, aluminum things are dear. And we haven't very much left to do our cooking in. All we got sent was

I would like to know if somebody has leased our land... " Mary's father, Katsuyori, asks the Custodian about the management of his farm.

2.
somebody else's kettle which was all enamel
plated. So could you please look into this
matter because we are in need of them badly.

I would like to know if we can get our garden
tools through the Custodian. If so please send

"... So could you please look into the matter
because we are in need of them badly."

Katsuyori requests that the Custodian
send the family their aluminum
kitchenware and garden tools and hose.

Yours truly
K. Murakami

Registration No. 10089

"Yours truly, K. Murakami"

We lived at Ganges.

Our Agent is Gavin Mouat

"We lived at Ganges. Our Agent is Gavin Mouat."

JUNE 26, 1943

EVACUATION SECTION

Haines JUN 30 1943
Katsuyori

Gastodian Office
Vancouver B.C.
Dear Mr. Green.

A few days ago the B.C.S.C. came and told us to pay the bill for the kitchen utensil and such articles which we got sent to us.

If you can remember, when we were chased out, we were told not to take anything except our clothing. Well, the people who came later from

"If you can remember, when we were chased out, we were told not to take anything except our clothing..."

thing they possessed. Luggage. And they got it sent free. What's the idea then. We didn't have anything to cook our meals with, so we sent for them. And besides when they come, "half of it was missing and but they couldn't get anything as bad as those utensil even if you went to a junk pile. They put in old boots which took half of the weight. And they tell us to pay for it."

Where do you think we can get the money for it, I think the B.C.S.C. is too severe. Besides we only get "22 1/2" an hour and we hardly can eat. People should do a little thinking and remember we aren't Indians. But we are any Canadian people living.

Katsuyori argues that it is unfair that he must pay for the shipment of his belongings.

"And where is the brand new garden hose we asked for. But somebody look it."

you know Gavin Mouat. Well when we
were leaving, he told us the Custodian would
repay everything stolen or lost. Well I think
that's the biggest lie a person can tell. If you
people don't agree where our new garden hose?

Even if the government is treating us as
an enemy alien, stealing doesn't come in. What
good are the laws which we learnt in school.

"And where is the brand new garden hose we asked
for... You know Gavin Mouat. Well when we were
leaving, he told us the Custodian would repay
everything stolen or lost. Well I think that's the
biggest lie a person could tell. If you people [don't]
agree, where is our new garden hose?"

...I think it to the people
this question. Where
to thing we got sent? And
if the other people
luggage free. If the
government thinks we're going to steal and
pay for it, they are badly mistaken. I would
like to have the answer soon.

Yours very truly
Alice Murakami

(Reg. No 10089) Mr. Katsuyori Murakami
former resident. Ganges, B.C.

"Alice Murakami
Mr. Katsuyori Murakami,
former resident Ganges, B.C."

Alice is Mary's older sister. Born in Canada,
she attended public school on Salt Spring
Island. It is possible that she wrote to the
Custodian on behalf of her father.

JULY 5, 1943

1364

July 5th, 1943

Miss Alice MURAKAMI,
Registration No. 10089,
House 208,
Rosebery, B. C.

Dear Madam:-

Thank you for your letter of June 26th from which we were very sorry to see that some of the articles asked for have not been received.

We are promptly taking up this matter with Mr. Mouat and will report to you as soon as we can. It is a fact that we have had great trouble with pilfering of Japanese effects but we have done whatever possible to protect your belongings.

Turning to the question of payment for shipments, we are afraid that this is a matter where we cannot help you and where you will have to apply to the Security Commission. You will appreciate that the movement of Japanese and the provision of necessities for them is solely the responsibility of the Security Commission and that this office is only charged with the protection of effects left behind.

Yours truly,

H. F. Green
Protection Department

HFG:IF
c/cs sent to Security Commission

H.F. Green is an agent at the Office of the Custodian. He promises Mary's sister, Alice, that he will contact Gavin Mouat to find out what happened to their missing belongings.

JULY 5, 1943

The Custodian's agent writes to Gavin Mouat about the Murakamis' belongings. Mouat represents the Office of the Custodian on Salt Spring Island. Before the uprooting, he was a friend of the Murakami family.

July 5th, 1943

Mr. Gavin Mouat,
R. P. #1,
Ganges, B. C.

Dear Sir:-

Re: Katsunori MURAKAMI

Our records show that the above Japanese registered with the Custodian at Hastings Park on March 20th, 1942 having left Salt Spring Island earlier than the other Japanese. We have on file your report and inventory of March 29th compiled by you.

On December 14th the Security Commission wrote direct to you enclosing a release for kitchen utensils, tools, and sewing machine, but apparently (Security Commission's letter of January 27th) shipment of the wrong items was made. Complaints were received from the Japanese and a subsequent request made for some garden tools. The Security Commission wrote to you again on March 7th.

We have now heard from this Japanese or rather, his daughter Alice, as follows.

"....Half of it was missing and I bet they couldn't get anything as bad as those utensils even if you went to a junk pile. They put in old boots which took half of the weight."

"....And where is the brand new garden hose we asked for. Bet somebody took it."

May we please have your comments promptly? We may say that we are rather disturbed about the position of chattels on Mayne and Salt Spring Islands. You have not answered any of our recent letters and experience has shown that if a very close check is not kept of effects such as tools, implements etc., they soon disappear. May we therefore have your comments as soon as possible?

Yours truly,

H. F. Green
Protection Department

HFG:IF
c/c sent to Security Commission

There is no record of Gavin Mouat's answer.

SEPTEMBER 18, 1943

Sept. 18, 1943
Hoschberg, B.C.

Mrs R. G. Bell
Administration Bldg
Office of the Custodian
Vancouver, B.C.

EVACUATION SECTION	
Rec'd	SEP 21 1943
File No.	1564
Ans.	RUB
Referred	Bell

out to you

Wesley Sir

I received your letter of Sept 14th And referring to the Agreement to Mr. J. F. Speed, the remaining amount, do

Mary's father, Katsuyori, requests that the Custodian release funds from the sale of his properties. "In regards to the balance of money for me, do you think I can get any out? The reason is that we need clothes for winter."

In regards to the balance of money for me, do you think I can get any out? The reason is, that we need clothes for winter. And we can't get any from the Commission, because I am working. We have seven in our family, and we can't even eat on the pay given to me. And as the winter is coming, we need some clothes for the children. Since April 22, 1942, we haven't hardly bought

"... we can't even eat on the pay given to me. As the winter is coming, we need some clothes for the children."

anything so bad. I have a daughter going to high school. She walks four miles to West Vancouver and four miles back. They haven't any transportation because we cannot get any. We have to buy her books and shoes and other things.

2
And it is pretty hard for a parent to say no when
she asked if she can buy herself a shoe. But she
has tried to wear it but I know I know she feels
Some of her friends can have nice clothes because
they are working in a family But how do you think
I can buy her shoes when we can't hardly put it on
wouldn't I have had to wear for things when we were
at home because we wasn't get enough to go on.
So if you can spare some of your money please
let us know

Yours very truly
Katsuyori W. Mahanah
Aug. 1008
Roseburg, B. C.

Katsuyori describes how one of his daughters walks eight kilometers each day to attend the internment camp school. After a year, her shoes have worn out. Katsuyori cannot afford to replace them on the government's limited payments.

"... it is pretty hard for a parent to say no when she asked if she can buy herself a shoe."

J.L. No. 782

Canada

**DEPARTMENT OF THE SECRETARY OF STATE
OFFICE OF THE CUSTODIAN**

JAPANESE EVACUATION SECTION

File No. 1364 ✓
Reg. No. 10089 ✓

506 Royal Bank Building,
Vancouver, B. C.

Mr. Katsuyori MURAKAMI, ✓
Roseberry, B. C.

Katsuyori is notified sometime in 1948 that his farm was sold to the The Director, The Veteran's Land Act.

Dear Sir:

✓ **Re: District of Cowichan- That part of the East Half of Section 3, Range 2 East, North Salt Spring Island, shown outlined in red on Plan 146R, containing 7.04 acres more or less. C. of T. 139613-1. and Lot 1 of Section 3, Range 2 E. North Division of Salt Spring Island, Plan 3912. C. of T. 85046-1.**

You have previously been advised that a sale of lands in rural districts was entered into between this Department and The Director, The Veterans' Land Act.

Due to the size of this transaction, the arrangements for same and the completion of the transfer have taken a considerable time. Negotiations were started in the early part of 1943 and were based upon valuations made by qualified appraisers and on the basis of a sale effective as at January 1st of that year. This means that the 1943 revenues from the property were for the benefit of the purchasers, but that taxes, fire insurance and other operating charges were assumed by them.

The following is a statement showing the sale price and adjustments:

Sale price of above described property	- - - - -	\$ 1,284.00
Add:		
Unexpired insurance premium as at January 1st, 1944	- - - - -	1.35
		<u>1,285.35</u>
Less:		
Tax arrears to December 31st, 1942	- - - - -	\$ 2.00 (Water Rental)
Registration fee	- - - - -	6.00 8.00
Encumbrance—Principal	- - - - -	
—Interest	- - - - -	
Net proceeds of sale	- - - - -	<u>1,277.35</u>

This amount has been placed to your credit and a statement of your account is endorsed hereon showing the present balance on our books. A small amount for legal fees in connection with the conveyance to the Veterans' land will be charged later.

Yours truly,
F. G. SHEARS,
Director.

